

TM
77N
EI

FIRE PROTECTION DOOR SYSTEM



excellent thermal insulation and safety

TM 77N EI - SYSTEM FEATURES

- excellent thermal insulation combined with fire protection in classes EI 30 and EI 60,
- XPS inserts were used in the EI 30 door, enabling even better thermal performance to be achieved. The EI 60 variant, on the other hand, uses GKF and RokuTherm inserts,
- new clips (prestige) with new gaskets,
- one type of ceramic gasket available in white or black,
- glazing plates to allow installation without undercutting the clips,
- possibility to use a three-point anti-panic lock with counter-cashing device, averse and reverse electric strikers, semi-automatic locking of the passive leaf,
- choice of expanding gasket between three manufacturers,
- door can be installed in the FA 50N EI facade,
- possibility of selecting glass manufacturer: Vetrotech Saint-Gobain, Bohamet, Polfam, Bojar, AGC.



See the product
on the website



Picture: Examples of the system use.

SECTION THROUGH A SINGLE LEAF
DOOR TM 77N EI 30

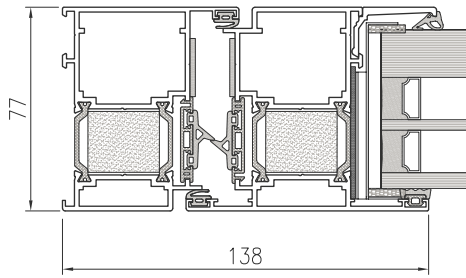

SECTION THROUGH A SINGLE LEAF
DOOR TM 77N EI 60

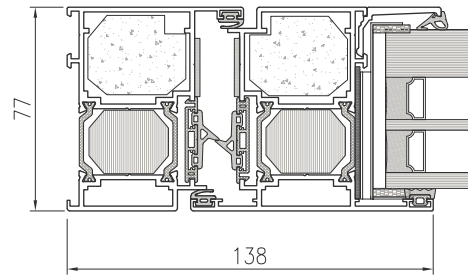

BOTTOM REBATE TM 77N EI 30

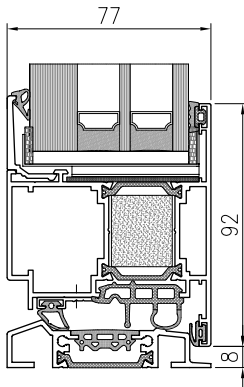

BOTTOM REBATE TM 77N EI 60

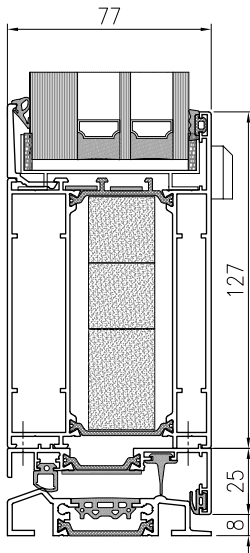
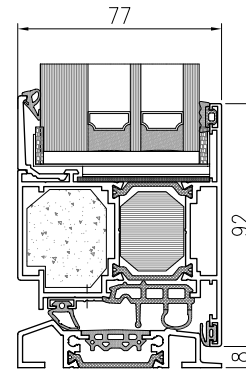

BOTTOM REBATE
TM 77N EI 30

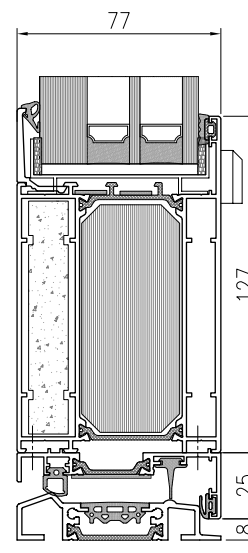

BOTTOM REBATE
TM 77N EI 60

TECHNICAL PARAMETERS - TM 77N EI

ENERGY	Thermal insulation EN 10077-2	Ud from 1,2 W/m ² K
COMFORT	Air permeability EN 12207	Class 4
	Water tightness EN 12208	Class E1200
SAFETY	Wind load resistance EN 12210	Class C4/B4
	Fire resistance EN 13501-2	EI 30, EI 60

TECHNICAL PROPERTIES - TM 77N EI

Frame structural depth	77 mm
Sash structural depth	77 mm
Infill thickness	from 61 mm
Maximum dimensions L x H	2500 x 2600 mm